



"The Value Leader in Temporary Space"™

Model 2460



.019 Aluminum Siding
Block Tile Flooring
Central HVAC

Building Size: 24'x56'
Skirting and Steps are
Options

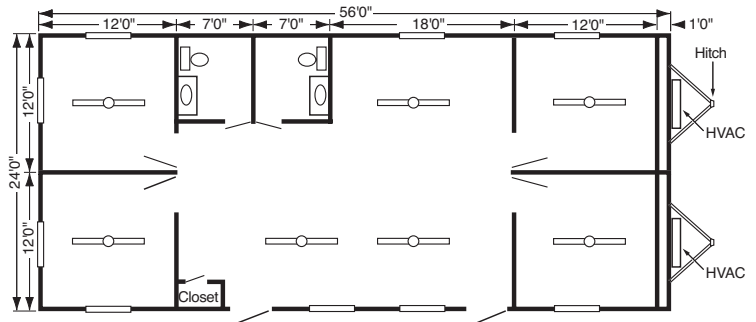
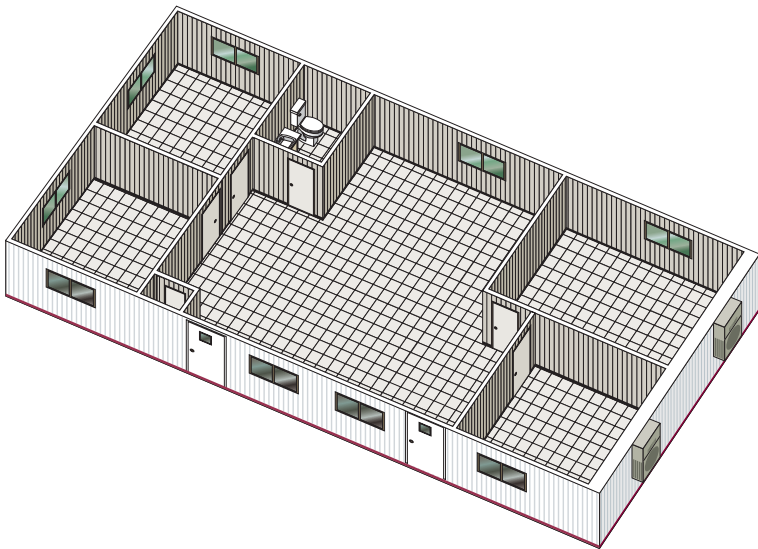

Floor plans may vary based on location.
Available with one or two restrooms.

800-251-1600
www.actonmobile.com

Offices in PA (2), VA (2), NC (2), GA, FL (3), AL (2), TN, KY, IL, TX (3), OK, SC